

Gyro Sensor

BST 83G3M Triaxial



CONTACT

+49 89 189 41 49-11

info@bay-sensortec.com

FEATURES

- Very small housing
- Low power consumption
- Low noise
- Aluminium Housing
- 0 Hz (DC)
- Calibration

APPLICATION

- Automotive Testing
- Train
- Truck & Busses
- Tractors



DESCRIPTION

The Model BST 83G3M is a triaxial Angular-Rate-Sensor, based on MEMS Technology and a very low power consumption between 5 Volt and 28 Volt. The sensor can be connected to all Data Acquisitions Systems in many applications like Automotive, Truck, Geology and Train application. The sensor is temperature compensated from -25 °C to 85 °C and has an Amplified Signal Output.

The small Aluminium Housing makes it easy to mount it on difficult places. The BST 83G3M is very shock resistant. The sensor has 6 m high flexible and rugged shielded PUR-cable.

DIMENSIONS

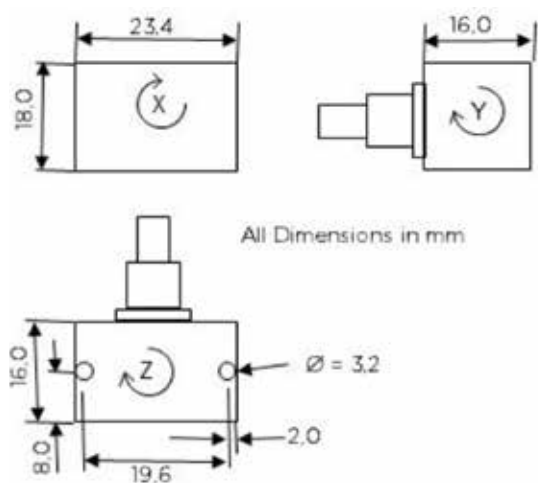

SPECIFICATION ACCELEROMETER

All data are typical at 23 °C AND 10 VDC SUPPLY.

Ranges (°/s)	75	150	300	900
Sensitivity typ. (mV/°/s)	13.5	6.7	3.3	1.2
Frequency (Hz)	100	100	100	100

ELECTRICAL PERFORMANCES

Supply voltage	5 to 28 VDC
Power Consumption	8 mA max.
Zero measurement output	1650 mV +/- 50 mV
Isolation	sensing element isolated from housing

ENVIRONMENTAL PERFORMANCES

Signal Spann	+/- 1,000 mVDC
Linearity	< 0,5 % FS typ.
Cross Axis Sensitivity	1 % typ. max. 3 %
Shock limit	2,000 g
TC Zero	0,03 %/°/s FSO
TC Signal	+/- 1 % typ. (+/- 3 % max.)
Operation Temperature	- 30 °C to + 100 °C
Storage Temperature	- 45 °C to + 125 °C
Protection Class	IP64
Housing Material	Aluminium, anodized
Dimensions	23.4 x 16.0 x 18.0 mm (l x w x h)
Weight Housing	23 grams without cable
Cable	integrated, 5-wire, shielded, AWG 30
Cable Length	6 m
Cable Shield	not connected to housing
Cable Material	PUR, black
Cable Weight	13 grams per meter, Ø 3.0 mm

CABLE CODE

red = Excitation +
black = Excitation -

white = Signal X
yellow = Signal Y
green = Signal Z

ORDER INFORMATION

BST 83G3M-300-6Z
83G3M = Model Name
300 = Range 300 °/S
6 = 6 m Cable
Z = no connector

OPTIONAL

Additional Cable Length
Connector
TEDS-Modul
Shunt Resistor